

## ERIKS USA - SE Products

Market know-how through strong customer relationships helps keep ERIKS on the forefront of industry needs. With a diverse and experienced technical staff ERIKS can aid in product selection as well as product development. This application know-how lets us be a partner not just a supplier. Being an international distribution company gives ERIKS a natural advantage in logistics know-how as we coordinate 60 operating companies in 13 countries. And finally our technical staff does much more than specify parts. They dig into the applications and offer solutions beyond the basic component level. This we call Product Processing know-how.

Through our E-Fab facility we can also design and manufacture the products that make up the ERIKS SE product line. This product line consists primarily of spring energized seals but with our vast knowledge of engineered plastics we can also help in the development of many other types of component parts and assemblies. ERIKS is an innovative, progressive and flexible partner to its customers and through our know-how we can offer support on just about any level.

Examples of the SE products offered by ERIKS USA include:

## Spring Energized Seals

Standard dash sizes as well as custom configurations.

- Cantilever Spring
- Spiral Pitch Spring
- Helical Spring
- O-Ring Energized

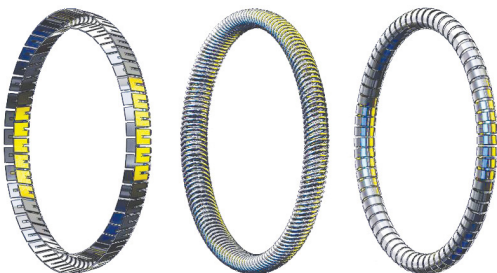

## Seal Types

- Rod
- Piston
- Face



High Speed Rotary Seals

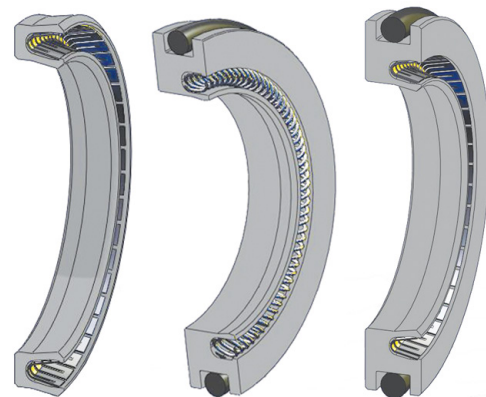

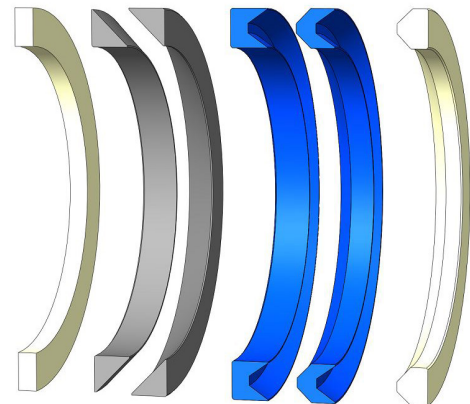

Machined Components



# technical action request

Date	Request	Eriks		 <a href="http://www.eriksusa.com">www.eriksusa.com</a>	Name		
Market	Project				Company		
Equipment	Part Number/Description				Street		
Target Life	Product Code	I.D.	O.D.		CSD	City	
Quality Requirements	Compound	Polymer	Duro		Color	ST	
Eriks Rep	\$	e.a.u.	Manufacturer		Tel		
E-mail							

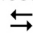
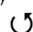
Fluid/Media		
Temp – Low	Temp – High	Unit °F / °C
Pressure – Average	Pressure – Peak	Unit psi / MPa / mTorr

<input type="checkbox"/> Reciprocating 	Stroke	in. / mm.	Speed	fpm/ mps
<input type="checkbox"/> Rotary 	Direction	C.W.   C.C.W.		Hz / rpm
<input type="checkbox"/> Other 	Runout	in. / mm.	Misalignment	in. / mm.
Other application comments:				

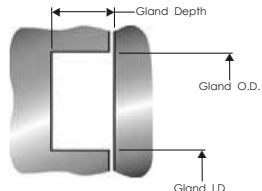
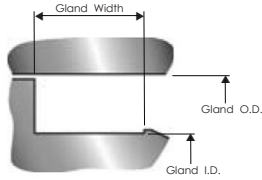
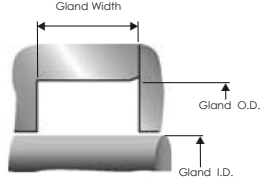
FACE	Description	Value	Unit
<input type="checkbox"/> INTERNAL <input type="checkbox"/> EXTERNAL 	Gland O.D.		in. / mm.
	±		
	Gland I.D.		
	±		
	Gland Depth		
	±		
	E-gap		
PISTON			
<input type="checkbox"/> 	Gland O.D.		in. / mm.
	±		
	Gland I.D.		
	±		
	Gland Width		
	±		
	E-gap		
<input type="checkbox"/> Open gland <input type="checkbox"/> Closed gland <input type="checkbox"/> Step gland			
ROD			
<input type="checkbox"/> 	Gland O.D.		in. / mm.
	±		
	Gland I.D.		
	±		
	Gland Width		
	±		
	E-gap		
<input type="checkbox"/> Open gland <input type="checkbox"/> Closed gland <input type="checkbox"/> Step gland			
BORE		SHAFT	
Material		Material	
Hardness	Rc/ ?	Hardness	Rc/ ?
Finish RA	µin/µm	Finish RA	µin/µm

Provide your own sketch

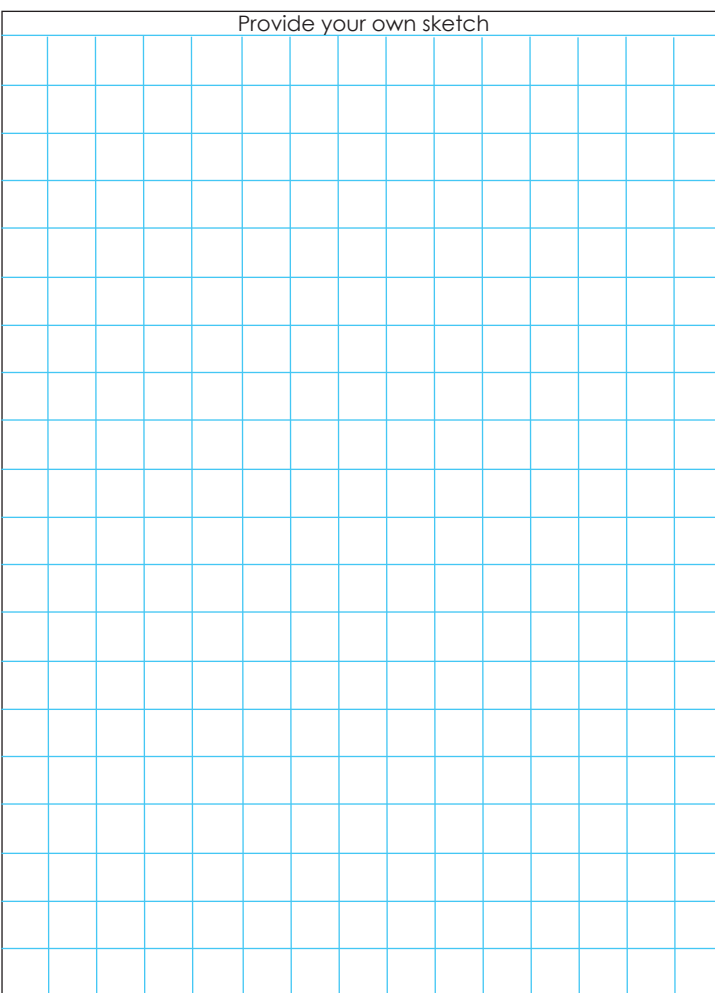

knowledgeable | innovative | unbiased | responsive